



8 The Avenue, Datchet, Slough, Berkshire, SL3 9DQ
£395,000

 **HORLER**

8 The Avenue, Datchet, Slough, Berkshire, SL3 9DQ

Situated on The Avenue in the desirable village of Datchet, this charming ground-floor maisonette offers modern and comfortable living. The property features two spacious double bedrooms, a contemporary fitted kitchen, and a bright open-plan living and dining area with patio doors opening onto a private rear garden, ideal for relaxing or entertaining. Conveniently located close to local amenities and excellent transport links, this home is perfect for couples, small families, or anyone seeking a well-connected village lifestyle.



Property Summary

In the charming area of The Avenue, Datchet, this delightful ground floor maisonette offers a perfect blend of comfort and modern living. With two spacious double bedrooms, this property is ideal for couples, small families, or those seeking a serene retreat.

Upon entering, you will be greeted by a contemporary fitted kitchen that is both stylish and functional, making it a joy to prepare meals. The open plan living and dining area is designed for relaxation and entertaining, featuring patio doors that lead directly to a lovely rear garden. This outdoor space is perfect for enjoying a morning coffee or hosting summer gatherings.

The location of this maisonette is particularly advantageous, as it is conveniently close to local amenities, ensuring that shops, cafes, and essential services are just a short stroll away. Additionally, the excellent transport links in the area make commuting to nearby towns and cities a breeze, providing easy access to the wider region.

This property presents a wonderful opportunity for those looking to settle in a vibrant community while enjoying the comforts of modern living. With its appealing features and prime location, this maisonette is not to be missed.

General Information

Legal Note

Although these particulars are thought to be materially correct their accuracy cannot be guaranteed and they do not form part of any contract





The Avenue SL3

Approximate Gross Internal Floor Area = 64.7 sq m / 697 sq ft

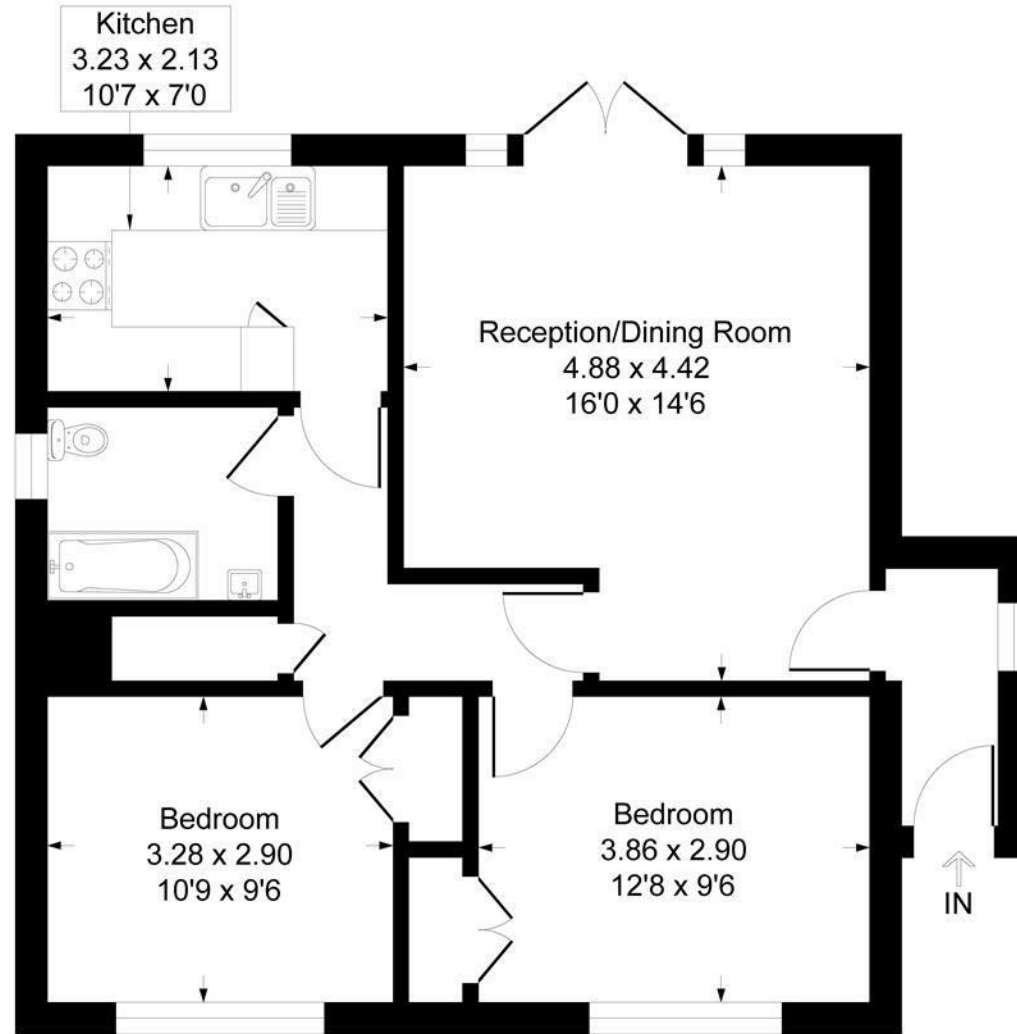

Ground Floor

Illustration for identification purposes only, measurements are approximate, not to scale.
Produced By Esjay Property Marketing